

#VITERBIADMIT OPEN HOUSE



Welcome to the Admitted Student Open House! Today's program provides you with information and experiences to help you decide which university you will attend. Meet our faculty, staff, and students as you explore class projects, research efforts, and student organizations. We are here today to help you learn more about the [@USCViterbi](#) experience, and hopefully have some fun too!

**SHARE YOUR TIME
WITH US USING
#VITERBIADMIT**



EXPLORE, DISCUSS, INVESTIGATE

Navigate the Open House by learning about the many ways students have built their #ViterbiLife. While there is way too much to list on this sheet, you can follow the map on the back to find areas of interest.



DESIGN TEAMS

Take engineering outside the classroom and build your next best idea for competitions across the disciplines. The Teams are outside on the patio.



INNOVATION

The startup community changes by the minute. Hear the latest pitches, and see a few of the up and coming entrepreneurial ventures by our students



COMMUNITY

Your time on campus will be spent building leadership skills and creating community in student organizations, professional societies... and just having some fun!



RESEARCH

Research in the Viterbi School is about improving society and making a difference. Come see a few of the research projects our students are working on with faculty.



INTERNATIONAL EXPERIENCES

Where do you want to go? Your engineering education can be complemented by a broad range of overseas programs.



ACADEMICS

In addition to scheduled faculty breakout sessions (see back), our academic focused student organizations can show you how they network with professionals in their area.



GET YOUR QUESTIONS ANSWERED

We know you have a tough choice to make. Join our academic advisors, career connections advisors, student engagement professionals and more to discuss any other questions you have about the Viterbi School.

FIRST FLOOR

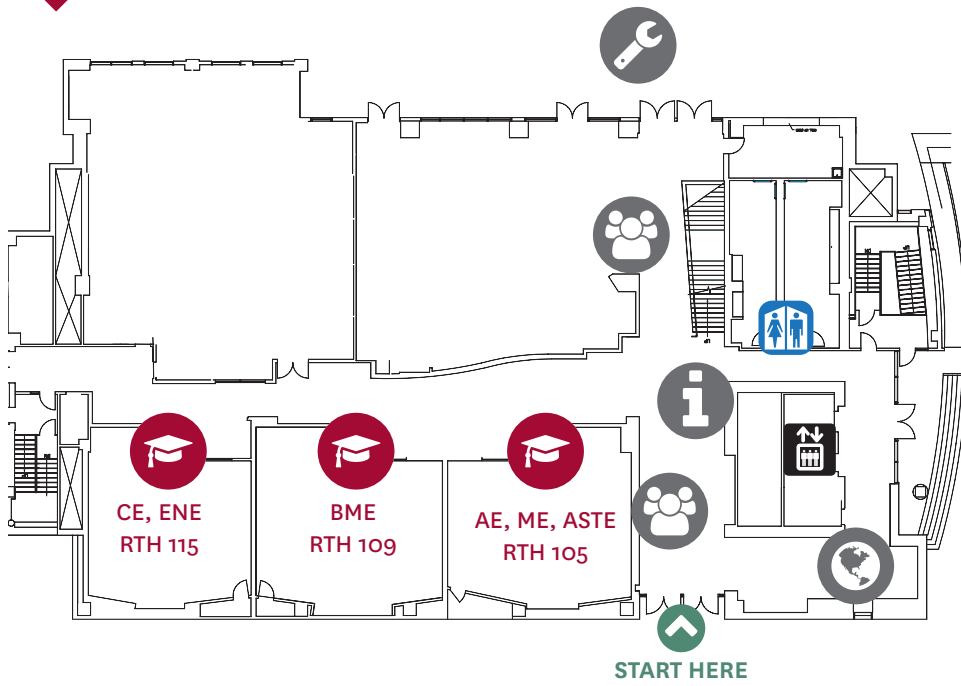

ACADEMIC BREAKOUT SESSIONS WITH FACULTY

AEROSPACE (AE)

1:00 PM & 2:00 PM
RTH 105

ASTRONAUTICAL (ASTE)

1:00 PM & 2:00 PM
RTH 105

BIOMEDICAL (BME)

1:00 PM & 2:00 PM
RTH 109

CHEMICAL (CHE)

1:30 PM & 2:30PM
RTH 324
*PROCEED DIRECTLY TO THIRD FLOOR,
TURN LEFT OUT OF ELEVATOR*

CIVIL (CE)

1:00 PM & 2:00 PM
RTH 115

SECOND FLOOR

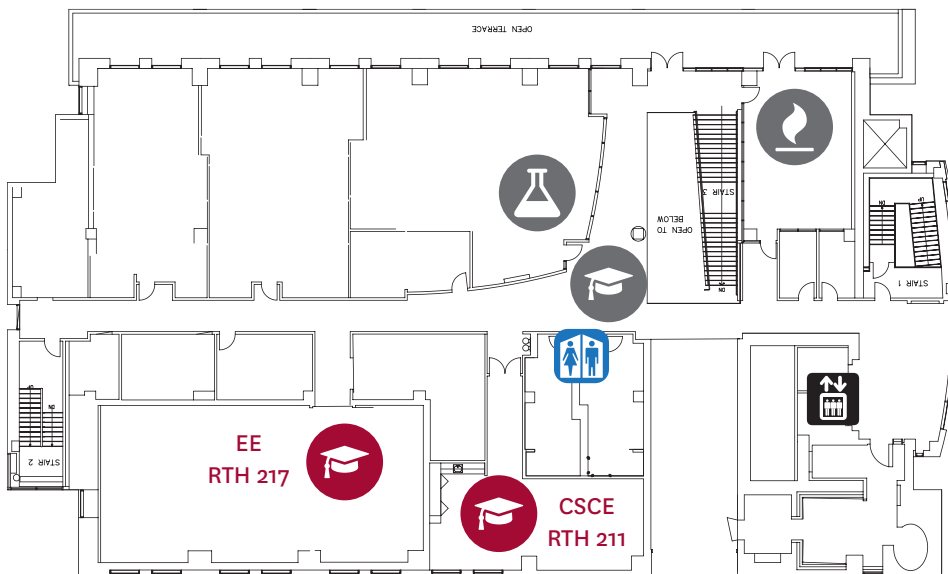

COMP. SCI & ENGR. (CSCE)

1:30 PM & 2:30PM
RTH 211

ELECTRICAL (EE)

1:30 PM & 2:30PM
RTH 217

ENVIRONMENTAL (ENE)

1:00 PM & 2:00 PM
RTH 115

INDUSTRIAL & SYSTEMS (ISE)

1:30 PM & 2:30PM
RTH 306
*PROCEED DIRECTLY TO THIRD FLOOR,
TURN LEFT OUT OF ELEVATOR*

MECHANICAL (ME)

1:00 PM & 2:00 PM
RTH 105

KEY

 DESIGN TEAMS	 ACADEMIC GROUPS	 COMMUNITY	 ELEVATORS
 INNOVATION	 RESEARCH	 OVERSEAS	 RESTROOM



Visit our information tables for more about:

**STUDENT ENGAGEMENT
CAREER CONNECTIONS
ACADEMIC ADVISEMENT
and more...**